

使用说明书

大家乐围炉



产品仅户外使用

产品型号：RB-01B

www.rischiervalley.com

重要：

使用前请仔细阅读这些说明。之前先熟悉一下设备将其连接至储气罐。保留使用说明书以供将来参考。

警告：

可触及的部件可能非常热。让幼儿远离。

1. 零件清单

1.1 标准版部件

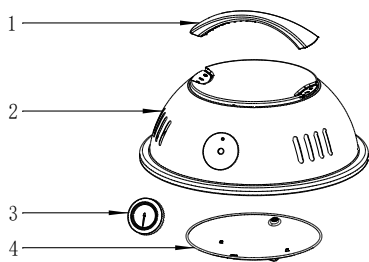

序号	名称	数量
1	把手	1
2	上盖组件	1
3	温度表	1
4	内隔热板组件	1
5	外环形烤板	1
6	中间烤板	1
7	小烤盘盖板	1
8	锅架	1
9	内壳	1
10	烤板起撬器	1
11	外壳组件	1
12	减压阀气管组件	1
13	小配件收纳袋	1

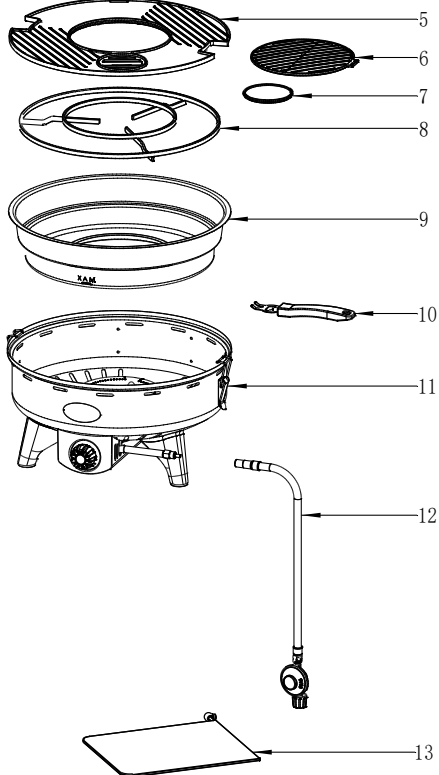

1.2 可选部件

1.2.1 支腿组件

序号	名称	数量
14	上支腿组件	3
15	盛物盘组件	1
16	下支腿(后)组件	1
17	下支腿(前)组件	2
18	支腿调节脚垫组件	1
19	支腿脚垫	2
20	炉脚端塞	3
21	支腿组件收纳袋	1

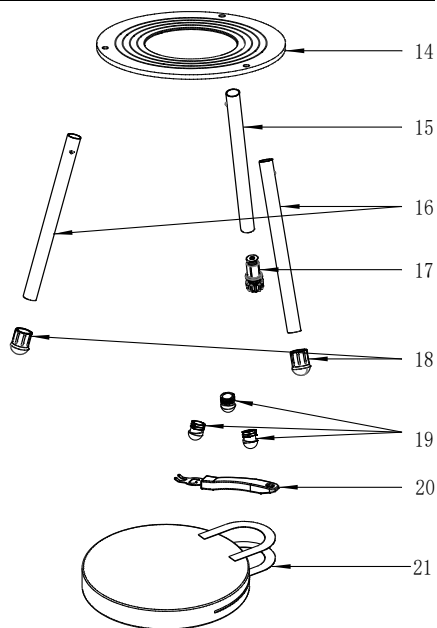

1.2.2 煮食配件

序号	名称	数量
22	鸳鸯锅	1
23	茶杯	1
24	茶杯收纳盒	4
25	茶壶	1
26	茶壶收纳袋	1

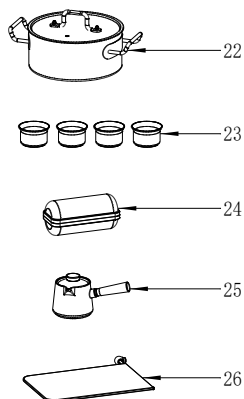

注意：

以上可选部件需要单独付费，请与销售人员核实，确保您订购的产品全部正确部分。

2. 安全信息

2.1 每次使用前以及连接到燃气容器前，必须检查燃气软管是否磨损或损坏。

2.2 如果设备软管损坏或磨损，请勿使用并更换软管。

2.3 请勿使用漏气、损坏或无法正常运行的燃气炉。

2.4 确保设备远离易燃材料。最小安全距离为：设备上方 1.2 米，后方和侧面 0.6 米。

2.5 确保燃气罐在室外安装或更换，远离任何火源，如明火、引火器、电火，并远离其他人。

2.6 使燃气罐远离热源和火焰。请勿放在燃气具或任何其他热表面上。

2.7 确保组装后的产品稳定且不会摇晃。

2.8 如果出现回火（火焰回燃并在喷嘴处点燃），请立即关闭燃气供应，方法是关闭燃气罐上的主控制阀，然后关闭燃气炉阀门。火焰熄灭后，拆下减压阀并检查其密封状况。

如有疑问，请更换密封件。按照操作图表中的说明重新点燃气炉。如果火焰持续回火，请将联系产品服务商。

2.9 如果您的设备有泄漏（有燃气气味），请立即将其带到室外无火焰的地方，以便检测和阻止泄漏。如果您想检查设备是否有泄漏，请在室外进行。不要尝试使用火焰检测泄漏；请使用肥皂水。

2.10 正确的方法是用肥皂水涂抹接头，例如阀体与气罐，及燃气具进气端配合处。

2.11 如果形成气泡，则表明有燃气泄漏。立即关闭燃气罐上的主控制阀，然后关闭燃气炉阀门，以关闭燃气供应。检查所有连接是否正确安装。用肥皂水重新检查。

2.12 如果燃气泄漏仍然存在，请将联系产品服务商。

2.13 可接触部件可能非常热，请让儿童远离。

2.14 仅在户外使用。

3. 技术规格:

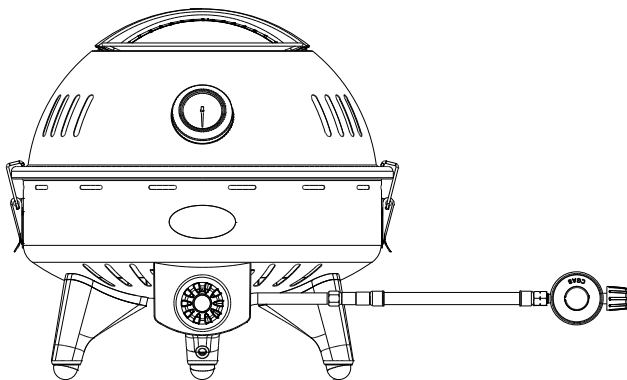

产品名称：大家乐围炉

产品净重：12.8kgs

产品尺寸：

- 标准版不带支腿组件：470×470×430 mm
- 可选版带支腿组件：620×590×980 mm

使用气压：2800 帕

燃气气种：丙烷/丁烷混合气体，适用高山罐小气瓶

燃气功率：4 千瓦

耗气量：290 克/小时（最大功率工作状况下）

烧烤面积：1640 平方厘米

适合场景：8~10 人户外聚餐

产品特点：

- 设计外观独特
- 结构紧凑
- 多功能煮食用途
- 打开和收纳方便
- 陶瓷漆处理易清洁
- 搪瓷内胆耐用

4. 安装说明

4.1 产品安装

当用户拿到样板后，打开包装箱取出整机后，首先自备十字螺丝刀，按整机附件上螺钉等配件（如图 1）安装上盖组件。



(图 1)

完整上盖组件组装，组装顺序按步骤 1，2，3：

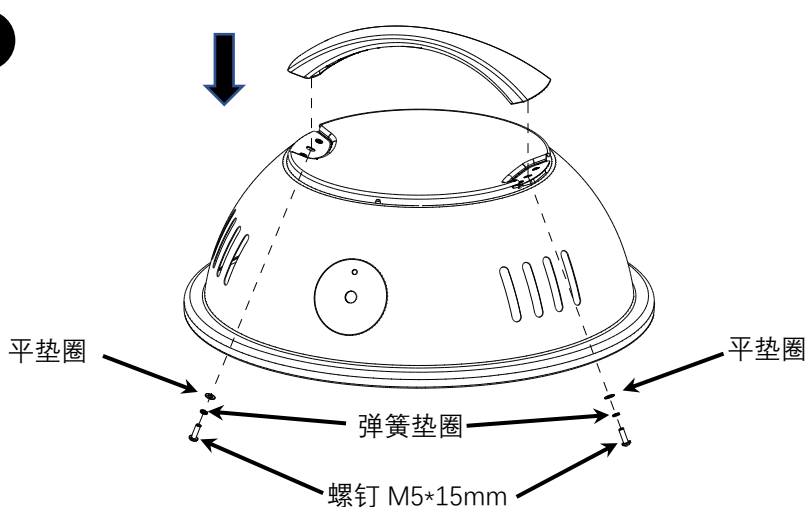

组装把手:螺钉 M5*15mm(2PCS)、平垫圈(2PCS)、弹簧垫圈(2PCS)

组装隔热板组件

2

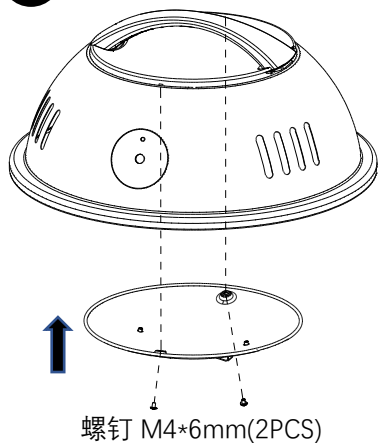

组装温度表

3

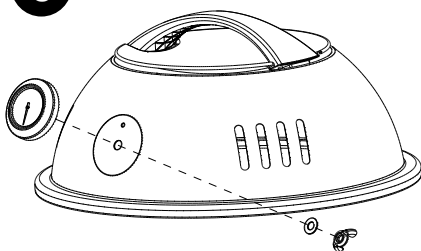

如有购买支腿组件组装，组装顺序按步骤 4 到 7，否则直接跳到步骤 8。

4

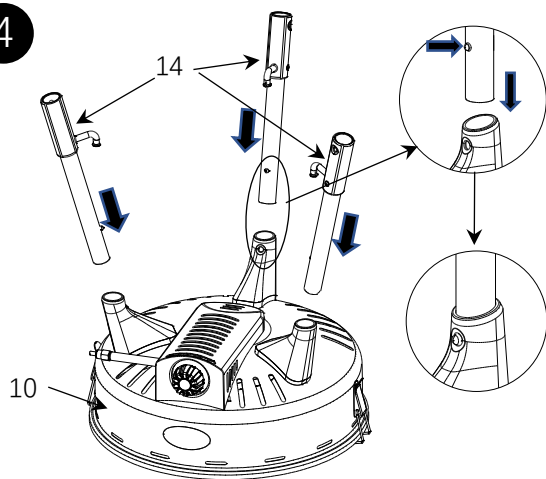

5

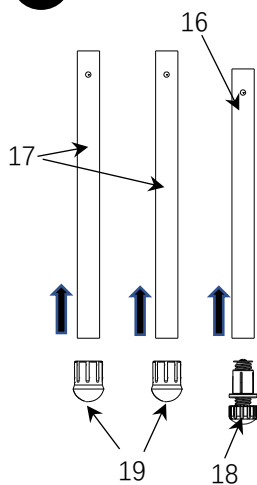

安装支腿前组件 17, 支腿后组件 16,
按步骤 6

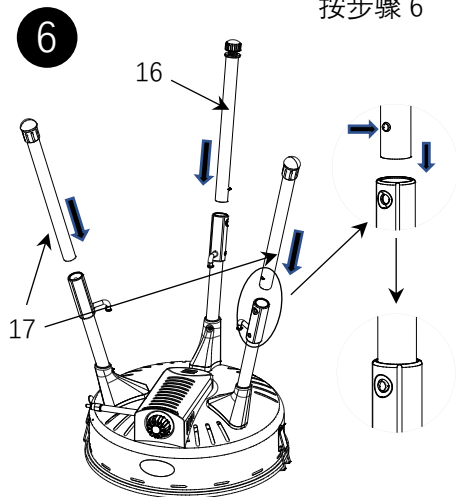

固定盛物盘组件 15, 按步骤 7

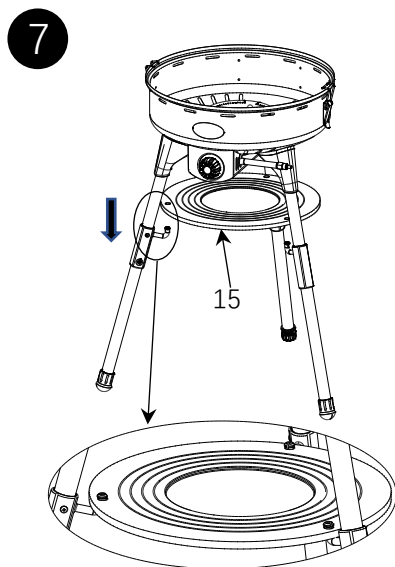

不带支腿组件的标准版组装,
装入炉脚端塞 20, 顺序按步骤 8。

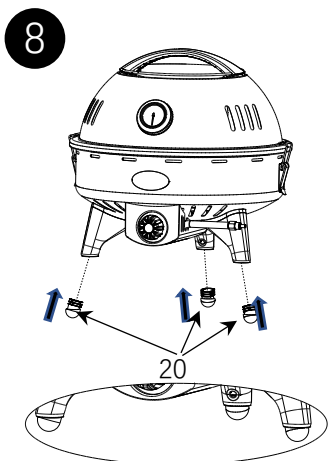

组装炉脚端塞(3PCS)

组装减压阀与连接管组件 12
按步骤 9

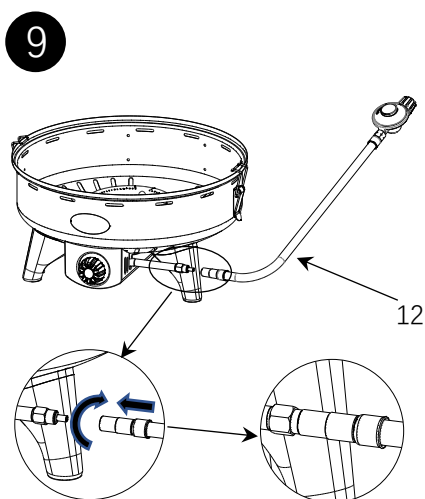

组装锅架 8，内壳 9，步骤 10

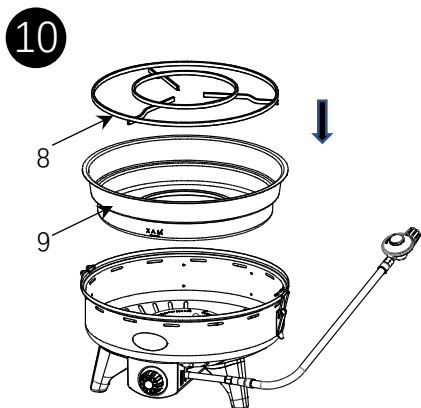

以下为三种不同多种煮食方式：

配置 1：纯烧烤模式

组装中间烤板 6 和小烤盘盖板 7。对于此模式，放置上盖组件时有助于提高或保持腔体内部温度，盖上的温度表可以帮助您评估内部温度；在侧放时它可以起到烧烤时防风作用，详细如步骤 11。

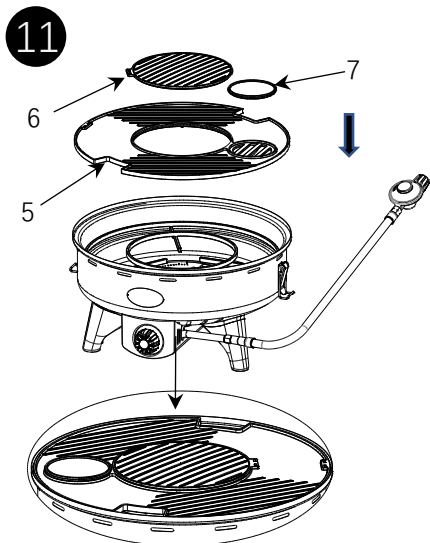

以下可选配件要单独购买：

配置 2：围炉煮茶模式

移去中间烤板 6，和小烤盘盖板 7
放上鸳鸯锅、茶壶，步骤 12

12

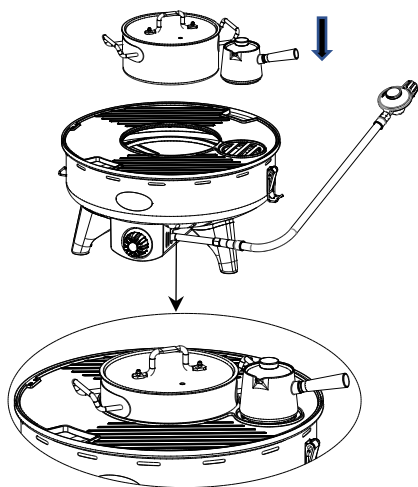

配置 3：烧水模式

移去中间烤板 6，放上水壶，步骤 13

13

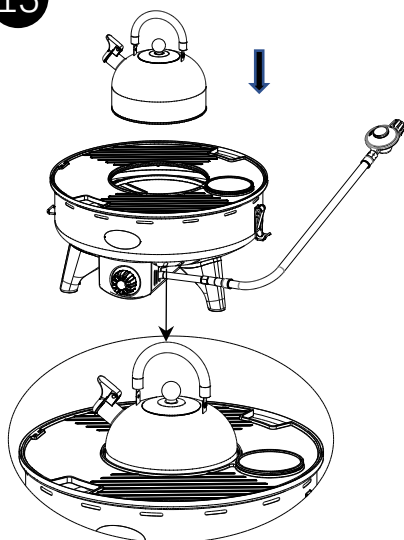

5. 连接进气

注意：

- 5.1 要求使用低压减压阀，请使用制造商或销售商推荐的减压阀
- 5.2 在组装减压阀之前，请检查气罐上的气体类型和压力，并确保减压阀和气罐上的信息相符
- 5.3 烤炉与气罐之间需有软管连接，最大允许值。长度不应超过 1.5 米
- 5.4 连接软管不能扭曲
- 5.5 烤炉在使用过程中必须远离易燃物品。
- 5.6 请勿将气罐放在烤炉下方，保持 40 厘米以上的距离。

气罐连接：

- 5.7 将烤炉连接到燃气或丙烷气管前，请确保燃烧器阀门处于“关闭”位置。
- 5.8 将烤炉进气口与减压阀出口连接。此连接必须使用液化石油气专用软管进行。
- 5.9 确保软管放置正确，没有被拉伸、打结或弯曲。
- 5.10 还要确保软管不要太靠近热源，尤其是烤炉本体。
- 5.11 本机附件的减压阀内置有手动开关阀，这用于打开或关闭燃气供应。该阀门必须位于易于接近的位置。

6. 燃气泄漏测试

- 6.1 将所有控制旋钮置于 OFF 位置
- 6.2 确保减压阀与气罐紧密连接。
- 6.3 转动气罐手动阀完全打开。如果听到急促的声音，请立即关闭煤气。连接处存在严重泄漏。在继续之前纠正。
- 6.4 将肥皂溶液刷到如下所示的指示连接处。
- 6.5 如果出现越来越大的气泡，则存在泄漏。如果发生煤气泄漏，请关闭煤气供应。如果无法阻止泄漏，请勿尝试修复。更换一个新的。
- 6.6 进行气罐泄漏测试后，务必通过转动手动阀关闭气罐阀门。
- 6.7 每次使用前，检查软管是否有破损或磨损。使用设备前更换损坏的软管组件。仅使用制造商或销售商指定的阀门/软管/减压阀。

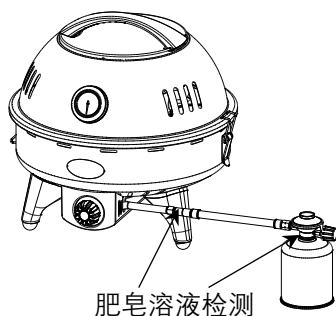

7. 点火操作

7.1 将所有阀门置于关闭位置。

7.2 打开气罐手动阀。

7.3 按下旋钮并逆时针旋转，您将听到阀门发出“咔嗒”声，并看到点火针冒出火花。重复此过程直至火焰被点燃。

注意：在点火和操作过程中切勿将手放在燃烧器上，否则可能会造成严重伤害。

注意：建议检查漏气后进行点火测试。试点火测试时，不要安装任何额外的部件，以便可以清楚地看到火焰。

如果点火测试正常，则关闭阀体。

8. 操作

警告：

- 使用过程中请勿移动设备，可触及部件可能非常热。只有在熄灭火焰并冷却后才能移动。
- 远离儿童。
- 使用后关闭气罐气源。
- 请勿在没有内胆的情况下使用烤炉。每次使用后或烧烤后4小时内请清理内胆，以防止多余滴落油脂积累在内胆而导致着火。
- 烧烤时请务必使用不过肥食物，以防脂肪爆燃。
- 若使用可调节支脚，可随时将3支脚置于同一水平面上。

8.1 点燃燃烧器后，转动旋钮即可获得所需火焰。



9. 断开气罐连接

- 关闭所有控制旋钮和气阀门。
 - 顺时针旋转螺母，从烤炉上拧开软管，从储气罐上断开减压阀。
- 请勿将气罐存放在儿童玩耍的地方。
 - 更换新气罐时，请远离火焰。

10. 清洁与维护

- 烤盘使用易清洁的陶瓷漆表面处理。建议使用洗涤剂、清洁剂和湿布清洁铝烤盘，请勿使用钢丝刷。用干布清除水分，并自然晾干部件。
- 建议每次使用后清洁附件。

注意：

- 请勿让水、汤和食物残渣进入燃烧器和煤气管道。
- 所有清洁和维护工作只能在设备冷却且关闭燃料供应的情况下进行。
- 每次使用后或烧烤一次 4 小时内请清理油盘，以防止油脂积累着火。

11. 维修

- 请将设备退回给销售商或致电合格人员进行维修和备件。请勿自行修理。

12. 产品收纳

12.1 标准配件收纳

按步骤 9 反方向操作，关闭小气罐减压阀开关，待工作耗尽余下气管内燃气至熄灭，然后关烤炉阀。使用烤板起撬器 10 移除烤盘作擦拭清洁，如步骤 14。

清洁后的中间烤板 6 和小烤盘盖板 7，与减压阀气管组件 12，烤板起撬器 10 一起装入配件收纳袋 20，如步骤 15。

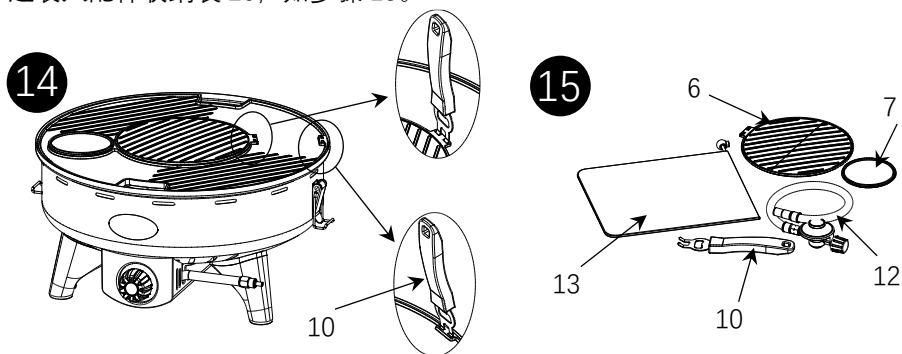

12.2 以下为可选配件收纳

产品有安装支腿组件，可以按步骤 7，6，4 的反方向操作，移除上下支腿组件。并把合共 6 件组件对应放在盛物盘组件的底部固定，并放入收纳袋，如步骤 16。清洁使用后的鸳鸯锅 22，茶壶 25 和茶杯 23，分别放在茶杯收纳盒 24，茶壶收纳袋 26。并分别放入鸳鸯锅 22 的两侧，放上锅盖。如步骤 17。

16

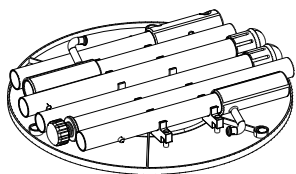

17

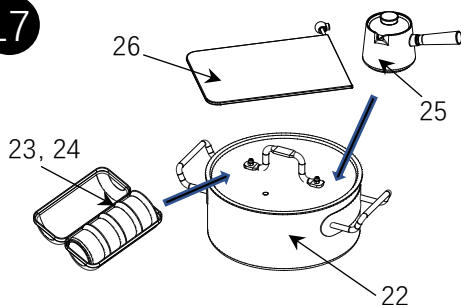

鸳鸯锅 22 放入中间烤板空位内，小配件收纳袋 13 放在鸳鸯锅 22 旁边，放上上盖组件 2 后，用两边盖扣压紧。整机便可适合手提移动，如步骤 18。

18

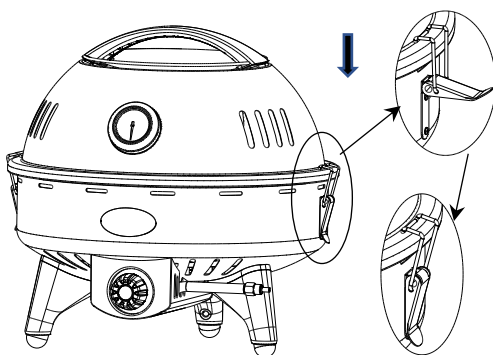
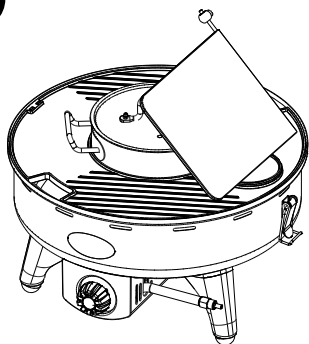

警告：这不是儿童玩具。

将产品存放在儿童接触不到的水平、稳定的地方。



Rischier Valley
瑞携川谷



Rischier Valley

户外多功能燃气烤炉

产品型号	CMG01LB
燃气类型	液化气
燃气压力	2800Pa
热输入功率 (kw)	4.0
耗气量 (g/h)	290

警告信息

1. 使用设备前请阅读本说明
2. 仅在室外使用
3. 警告: 可触及部件可能非常热, 让年幼的孩子远离
4. 运行过程中严禁移动, 只有在熄灭火焰并冷却后才能移动
5. 连接野营炉前请检查燃气类型, 不合适的燃气会造成严重危险
6. 如搭配选购的炉脚组件使用, 可调节脚使3个支脚处于同一水平面上
7. 请检查手册中的型号详细信息



100% Recyclable

版权所有 ©2024 Rischier Valley 瑞携川谷, 保留所有权利。



Rischier Valley
瑞携川谷

(此页面应为空白)

User Manual

Gas outdoor grill



Product is for outdoor use only

Model: RB-01B

www.rischiervalley.com

Important:

Please read these instructions carefully before use. Familiarize yourself with the device before connecting it to the gas tank. Retain the instruction manual for future reference.

Warning:

Accessible parts may be extremely hot. Keep children away.

1. Parts List

1.1 Standard version components

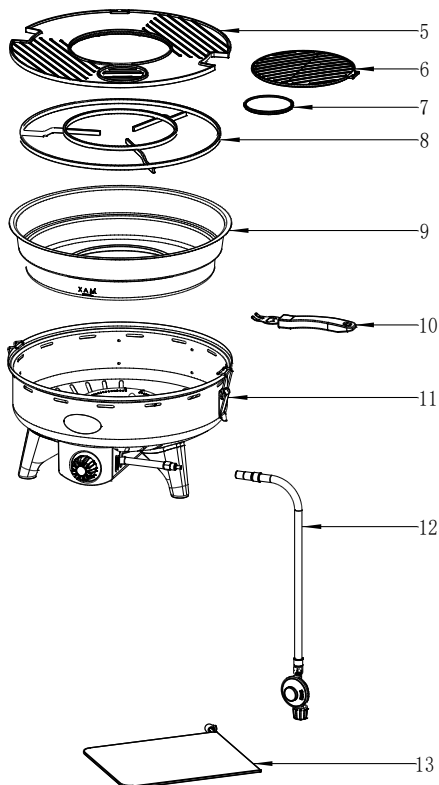
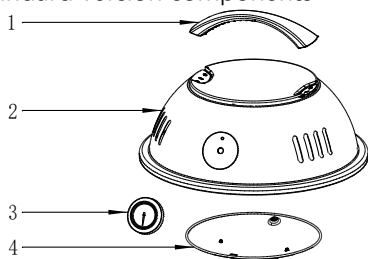

No.	Parts	Qty
1	Handle	1
2	Upper lid assy	1
3	Temperature gauge	1
4	Inner insulation plate	1
5	Main griddle	1
6	Middle griddle	1
7	Small griddle	1
8	Pot rack	1
9	Inner chassis	1
10	Griddle lifter	1
11	Housing assy	1
12	Regulator hose assy	1
13	Accessories storage bag	1

1.2 Optional Components

1.2.1 Leg Assembly

No.	Parts	Qty
13	Upper leg assy	3
14	Serving tray assy	1
15	Lower leg(rear) assy	1
16	Lower leg(front) assy	2
17	Leg adjust block assy	1
18	Leg foot pads	2
19	Main leg end plug	3
21	Leg assy storage bag	1

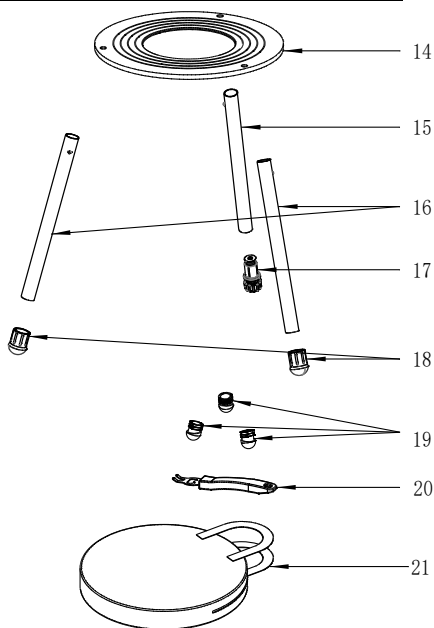

1.2.2 Cooking Accessories

No.	Parts	Qty
22	Hot pot with divider	1
23	Tea cup	4
24	Tea cup storage box	1
25	Tea pot	1
26	Tea pot storage bag	1

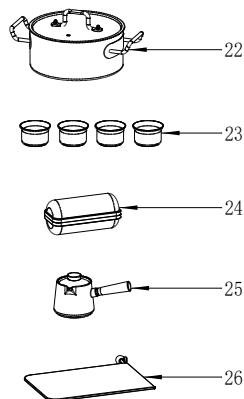

Notice:

The above optional parts are sold separately, please check with the

salespersons to ensure that you order all the correct parts.

2. Safety Information

2.1 Before each use and before connecting to a gas cylinder, the gas hose must be checked for wear or damage.

2.2 If the equipment hose is damaged or worn, do not use and replace the hose.

2.3 Do not use a gas stove that is leaking, damaged or not functioning properly.

2.4 Ensure the equipment is away from flammable materials. The minimum safe distance is: 1.2 meters above the equipment, 0.6 meters behind and to the sides.

2.5 Ensure that the gas cylinder is installed or replaced outdoors, away from any ignition sources such as flames, pilots, electrical fires, and away from other people.

2.6 Keep the gas cylinder away from heat and flames. Do not place on a gas appliance or any other hot surface.

2.7 Ensure that the assembled product is stable and will not shake.

2.8 If a flashback occurs (the flame goes back and ignites at the nozzle), immediately shut off the gas supply by closing the main control valve on the gas cylinder and then the gas burner valve. After the flame has gone out, remove the regulator and check its sealing condition.

If in doubt, replace the seal. Relight the burner as instructed in the operating chart.

If the flame continues to flash back, please contact the product service provider.

2.9 If your appliance is leaking (smell of gas), immediately take it outside to a flame-free area so that the leak can be detected and stopped. If you want to check the appliance for leaks, do it outside. Do not try to detect leaks with a flame; use soapy water instead.

2.10 The correct method is to apply soapy water to the joints, such as the joints between the regulator and the gas cylinder, and the appliance gas inlet.

2.11 If bubbles form, there is a gas leak. Immediately close the main control valve on the gas tank and then the burner valve to shut off the gas supply. Check that all connections are properly installed. Recheck with soapy water.

2.12 If the gas leak still occurs, please contact the product service provider.

2.13 Accessible parts may be very hot, please keep away from children.

2.14 For outdoor use only.

3. Technical specifications:

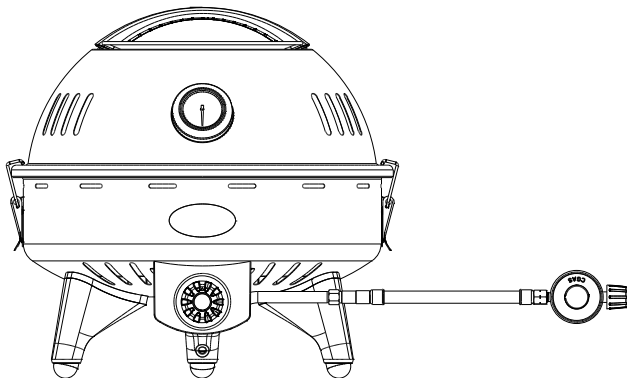

Product name: Outdoor camping BBQ (Tea brewing by the hearth)

Product Net Weight: 12.8kgs

Product size:

- Standard version without Leg Assy: 470×470×430 mm
- Optional version with Leg Assy: 620×590×980 mm

Gas pressure: 2800 Pa

Gas type: Propane/butane mixed gas, suitable for gas canister

Power input: 4 kW

Gas consumption: 290g/hour (at maximum power)

Grilling area: 1640 square centimeters

Suitable for: Outdoor gatherings for 8 to 10 people

Features:

- Unique design and appearance
- Compact structure
- Versatile cooking use
- Easy for installation and storage
- Ceramic paint treatment, easy to clean

- Durable enamel inner chassis

4. Installation Instructions

4.1 Product Installation

When the user gets the sample, open the package and take out the whole machine. First, bring your own cross screwdriver and install the upper cover assembly according to the screws and other accessories on the whole machine accessories (as shown in Figure 1).

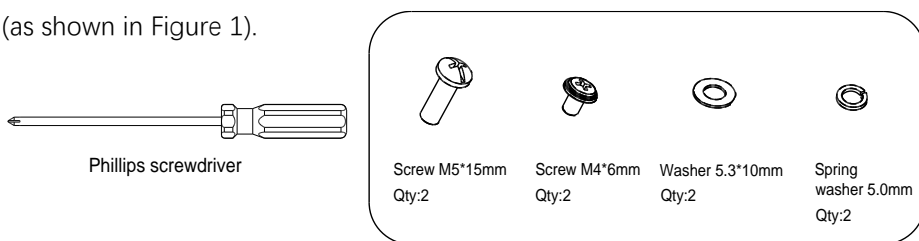

(Figure 1)

Complete upper cover assembly, assembly order is steps 1, 2, 3:

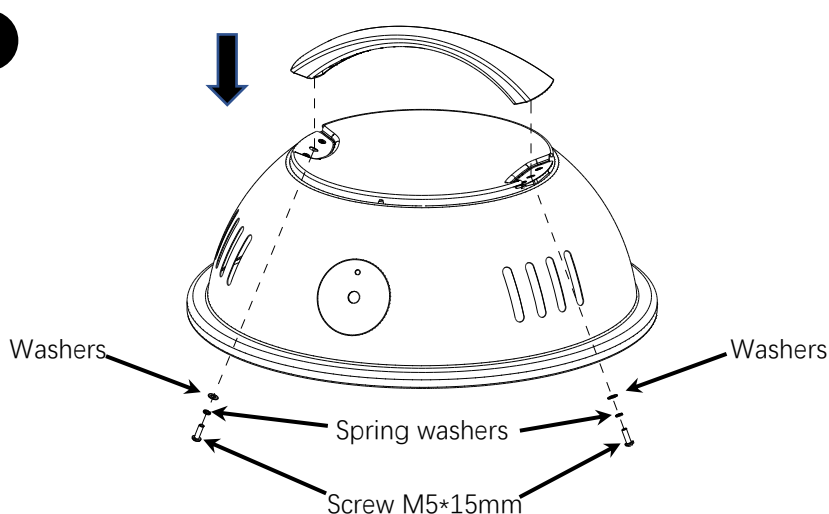

Assembling handle: screw M5*15mm (2PCS), washer (2PCS), spring washer (2PCS)

Assembling the inner insulation plate

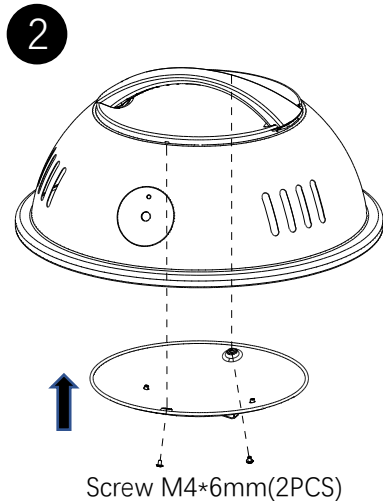

Assembling temperature gauge

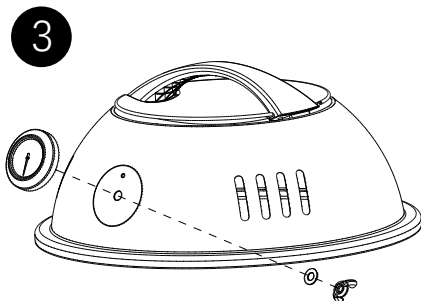

If you purchased the leg assembly, follow steps 4 to 7 for assembly, otherwise skip to step 8.

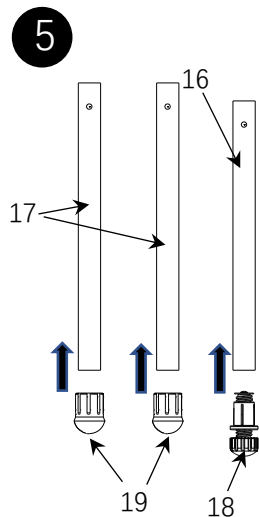
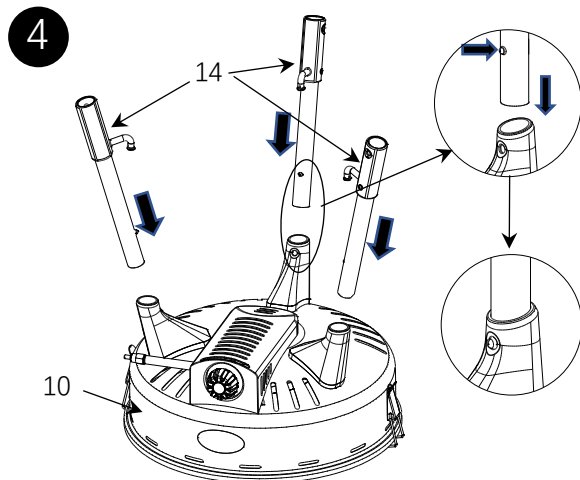

Install Lower leg(front) assy 17, and
Lower leg(rear) assy 16, follow step 6

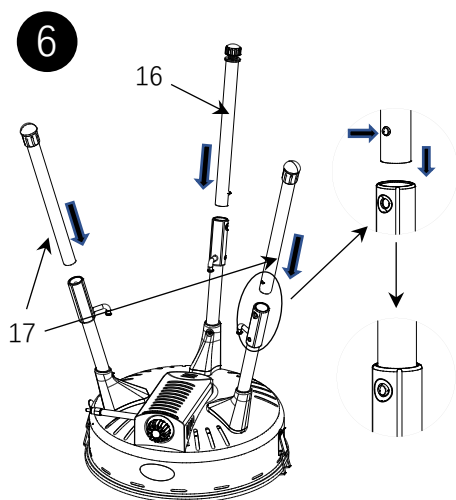

Fix the Serving tray assy 15,
Follow step 7

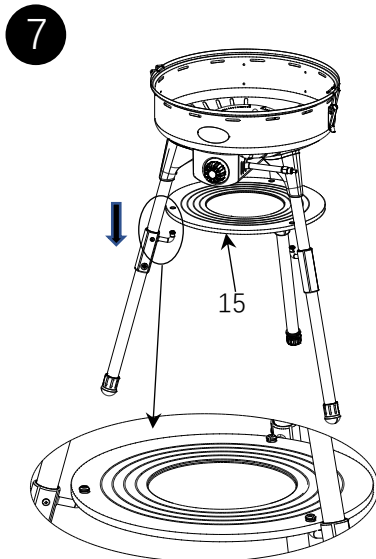

Standard version without leg assembly,
Insert Main leg end plug 20, for Step 8.

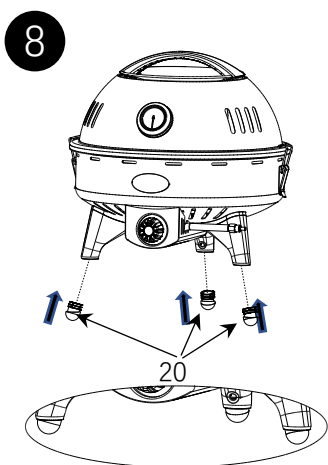

Assemble regulator hose assy 12
Follow step 9

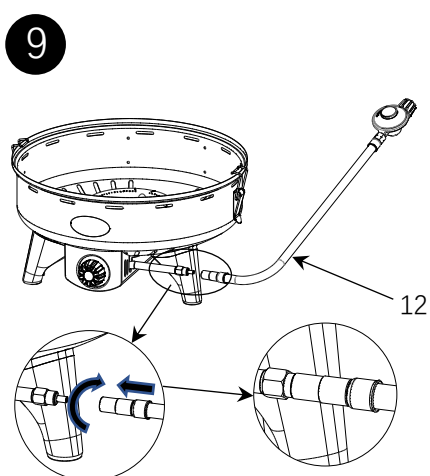

Main leg end plug (3PCS)

Assemble the Pot rack 8, inner chassis 9, step 10

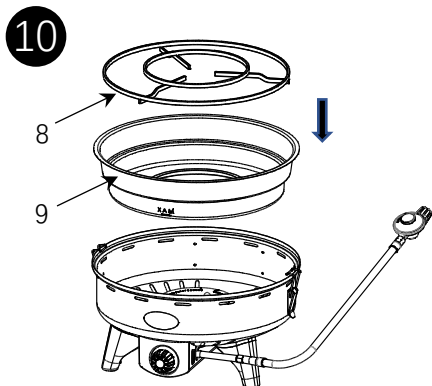

Here are three different cooking methods:

Config 1: Grilling mode

Assemble the Middle griddle 6 and the Small griddle 7. For this mode, placing the Upper lid assy helps to increase temperature or maintain the heat inside the chamber. The temperature gauge on the lid can help you assess the internal temperature; When placed on its side, it can act as a wind shield during grilling, as detailed in step 11.

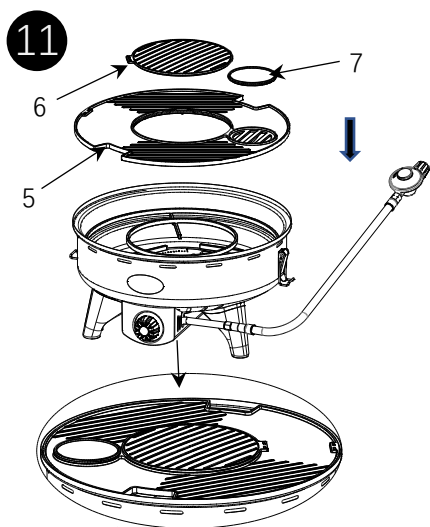

The following optional accessories need to be purchased separately:

Config 2: Tea brewing by the hearth
Remove the Middle griddle 6 and the Small griddle 7. Put the Hot pot and teapot on, step 12

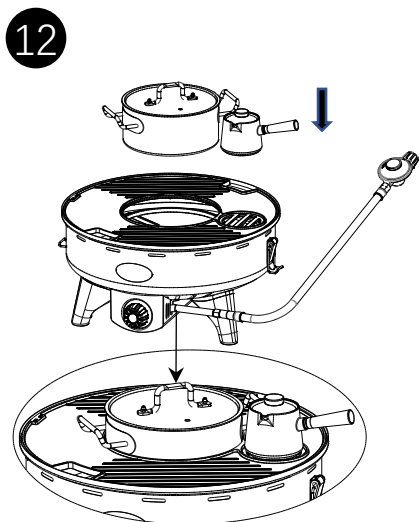

Config 3: Boiling water mode
Remove the Middle griddle 6 and place the kettle on top. Step 13

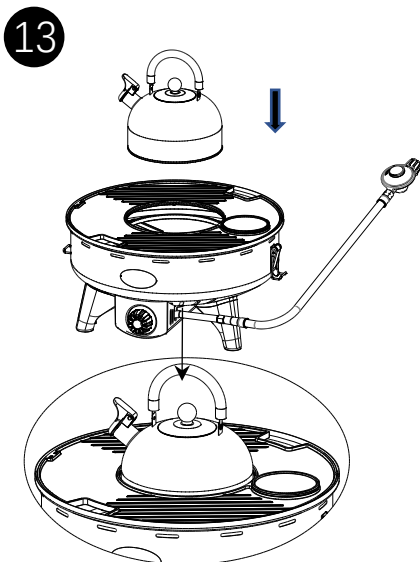

5. Connect gas to the grill

Notice:

5.1 Low-pressure regulator is required, please use it recommended by the manufacturer or seller.

5.2 Before assembling the regulator, please check the gas type and pressure on the gas cylinder and make sure that the info matched the regulator and gas cylinder.

5.3 There must be a hose connection between the BBQ grill and the gas cylinder, the maximum allowable length should not exceed 1.5 meters

5.4 The connecting hose cannot be twisted

5.5 The grill must be kept away from flammable objects during use.

5.6 Do not place the gas cylinder under grill, keep a distance of more than 40 cm.

Gas cylinder connection:

5.7 Before connecting the grill to the gas or propane line, make sure the burner valve is in the "off" position.

5.8 Connect the grill gas inlet to the regulator outlet. This connection must be made using a special hose for liquefied petroleum gas.

5.9 Ensure the hose is positioned correctly and is not stretched, kinked or bent.

5.10 Ensure that the hose is not too close to heat sources, especially the grill itself.

5.11 The accessory of regulator is equipped with a manual valve, which is used to open or close the gas supply. The valve must be located in an easily accessible position.

6. Gas leak test

6.1 Set all control knobs to the OFF position

6.2 Ensure that the regulator is tightly connected to the gas cylinder.

6.3 Turn the gas cylinder manual valve fully open. If you hear a rushing sound, turn off the gas immediately. There is a serious leak at the connection. Correct it before continuing.

6.4 Brush the soap solution onto the indicated connections as shown below.

6.5 If bubbles appear that are getting bigger, there is a leak. If a gas leak occurs, turn off the gas supply. If you cannot stop the leak, do not try to repair it. Replace it with a new one.

6.6 After performing the gas cylinder leak test, be sure to close the regulator valve manually.

6.7 Before each use, check the hose for damage or wear. Replace damaged hose assemblies before using the equipment. Only use the regulator specified by the manufacturer or seller.

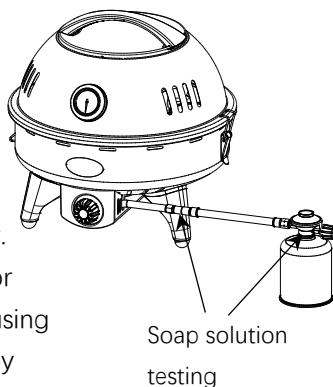

7. Ignition operation

7.1 Place all valves in the closed position.

7.2 Open the gas cylinder manual valve.

7.3 Press the knob and turn it counterclockwise, you will hear the valve "click" and see sparks coming out of the ignition needle. Repeat this process until the flame is ignited.

CAUTION: Do not place your hands on the burner during ignition and operation, as serious injury may result.

Note: It is recommended to perform an ignition test after checking for leaks. When performing the ignition test, do not install any additional parts so that the flame can be clearly seen.

If the ignition test is normal, close the valve body.

8. Operation

Warning:

- Do not move the device during use. Accessible parts may be very hot. Move it only after the flame has been extinguished and the device has cooled.
- Keep away from children.
- Turn off the gas supply to the cylinder after use.
- Do not use the grill without the inner chassis placed. Clean the inner chassis after each use or within 4 hours after grilling to prevent excess dripping grease from accumulating in the inner chassis and causing fire.
- When grilling, use not overly fatty foods to prevent fat from flaring.
- If using the feet with adjustable block, all 3 feet can be placed on the same level surface at all times.

8.1 After lighting the burner, turn the knob to obtain the desired flame.



9. Disconnect the gas tank

- Close all control knobs and gas valves.
- Unscrew the hose from the grill by turning the nut clockwise, and disconnect the regulator from the gas cylinder.
- Do not store gas cylinders where children play.
- Keep away from flames when replacing a new gas cylinder.

10. Cleaning and maintenance

- The griddle is painted with an easy-to-clean ceramic finish. It is recommended to use detergent, cleaner and a damp cloth to clean the aluminum griddle. Do not use a wire brush. Remove moisture with a dry cloth and air dry the parts.
- It is recommended to clean the accessories after each use.

Notice:

- Keep water, soup and food residues away from the burner and gas pipes.
- All cleaning and maintenance work may only be carried out when the unit is cool and the fuel supply is switched off.
- Clean the grease pan after each use or within 4 hours of grilling to prevent grease accumulation to cause fire.

11. Repairs

- Return the device to the place of purchase or call qualified personnel for repairs and spare parts. Do not perform repairs yourself.

12. Product Storage

12.1 Standard accessories storage

Follow the reverse operation of step 9, close the switch of the gas cylinder regulator, wait until the left gas in the hose is exhausted and extinguished, and then close the burner valve. Use the Griddle lifter 10 to remove the griddle and wipe it clean, as shown in step 14.

The cleaned middle griddle 6 and small griddle 7 are put into the accessory

storage bag 13 together with the regulator hose assembly 12 and the griddle lifter 10, as shown in step 15.

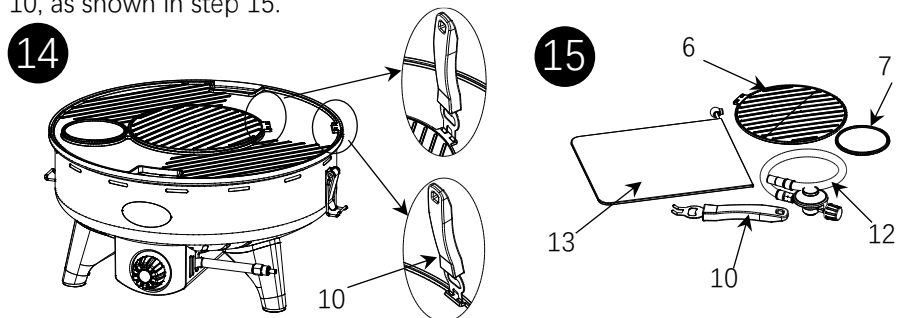

12.2 The following are optional accessories storage

The product has installed leg assemblies. You can remove the upper and lower leg assemblies by following the reverse directions of steps 7, 6, and 4. Place the total of 6 assemblies on the bottom of the Serving tray assy and fix them, and put them into the storage bag, as shown in step 16.

After cleaning and use, the hot pot kettle 22, teapot 25 and teacup 23 are placed in the teacup storage box 24 and teapot storage bag 26, respectively. They are placed on both sides of the hot pot with divider 22 and covered with a pot lid, as shown in step 17.

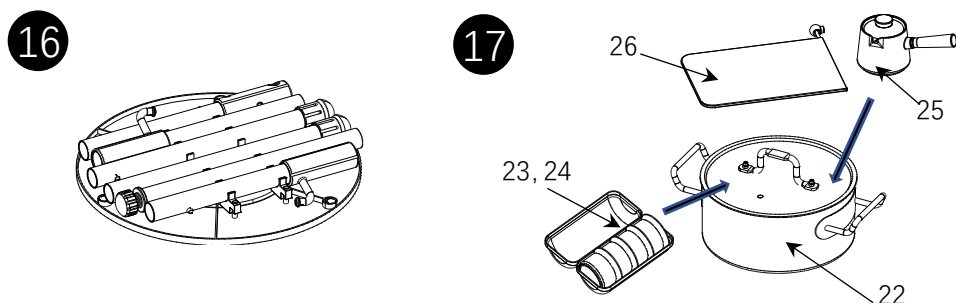

Put the hot pot with divider 22 into the empty space on the middle griddle, put the accessory storage bag 13 next to the hot pot 22, put the upper lid assembly 2 on, and press it tightly with the lid buckles on both sides. The whole machine is then suitable for portable movement, as shown in step 18.

18

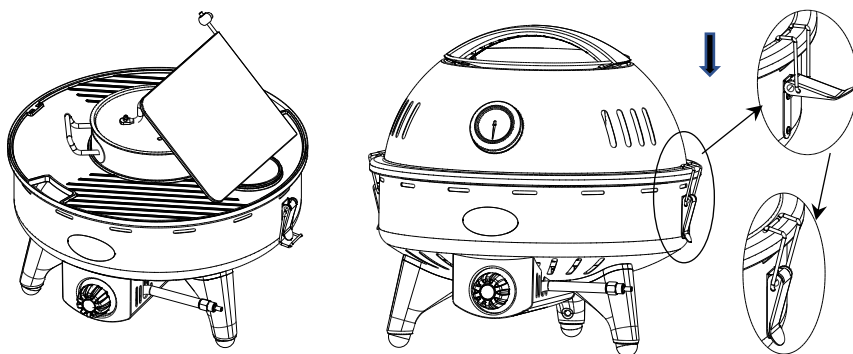

WARNING: This is not a children's toy.

Store product in a level, stable place out of reach of children.



Gas outdoor grill

Product model	CMG01LB
Gas type	Butane/Propane mixed
Gas pressure	2800Pa
Power input(kw)	4.0
Gas consumption(g/h)	290

Warning

1. Please read this instruction before using the device
2. Use outdoors only
3. Warning: accessible parts are very hot, keep young children away
4. Do not move during operation, only move after the flame is extinguished and cooled
5. Check the gas type before connecting the camping stove. Inappropriate gas will cause serious danger.
6. If using the optional leg kit, use the adjustable feet so that the three feet are on the same level
7. Please check the model details in the manual



100% Recyclable



(This page is intended to be blank)